



# **ALUMA-CLASSIC™ FENCE**

## **W1716 & W1720**



# **INSTRUCTION MANUAL**

**Phone: 1-360-734-3482 • On-Line Technical Support: [tech-support@shopfox.biz](mailto:tech-support@shopfox.biz)**

**COPYRIGHT © APRIL, 2004 BY WOODSTOCK INTERNATIONAL, INC. REVISED FEBRUARY, 2015 (BL)**

**WARNING: NO PORTION OF THIS MANUAL MAY BE REPRODUCED IN ANY SHAPE OR FORM WITHOUT**

**THE WRITTEN APPROVAL OF WOODSTOCK INTERNATIONAL, INC.**

**Printed in Taiwan**



# Contents

<b>INTRODUCTION</b>	<b>2</b>
About Your New Aluma-Classic™ Fence	2
Woodstock Service and Support	2
Get To Know Your Fence	3
Unpacking	3
Fence Controls	3
<b>ASSEMBLY</b>	<b>4</b>
Inventory	4
W1716 Installation	5
W1720 Installation	6
<b>ADJUSTMENTS</b>	<b>9</b>
Fence Parallelism	9
Scale Installation & Adjustment	10
<b>PARTS</b>	<b>11</b>

USE THE QUICK GUIDE PAGE LABELS TO SEARCH OUT INFORMATION FAST!





# INTRODUCTION

## About Your New Aluma-Classic™ Fence

Your new **SHOP FOX®** Model W1716/W1720 Aluma-Classic™ Fence is specially designed to provide many years of trouble-free service. Close attention to engineering detail, ruggedly built parts, and a rigid quality control program assure safe and reliable operation.

The Aluma-Classic™ Fence features an extruded aluminum and steel construction, utilizing a sturdy T-shape design that fits most table saws easily. The Model W1716/W1720 also features a single cam locking lever, magnified cursor lens and standard 57" rails. The Model W1720 is exactly the same as the Model W1716 except it features 79" extruded aluminum rails for wide panel cutting up to 50" right of the blade.

For more features and details, refer to the **Specifications** sub-section in this manual.

Woodstock International, Inc. is committed to customer satisfaction in providing this manual. It is our intent to include all the information necessary for safety, ease of assembly, practical use and durability of this product.

If you need the latest edition of this manual, you can download it from <http://www.shopfox.biz>.  
If you still have questions after reading the latest manual, or if you have comments please contact us at:

**Woodstock International, Inc.**  
**Attn: Technical Support Department**  
**P.O. Box 2309**  
**Bellingham, WA 98227**

## Woodstock Service and Support

We stand behind our machines! In the event that a defect is found, parts are missing or questions arise about your machine, please contact Woodstock International Service and Support at 1-360-734-3482 or send e-mail to: [tech-support@shopfox.biz](mailto:tech-support@shopfox.biz). Our knowledgeable staff will help you troubleshoot problems, order parts or arrange warranty returns.

# Get To Know Your Fence

For proper operation it is important to know your machine and its components. Please take the time to learn the features shown in **Figure 1 & 1a** below.

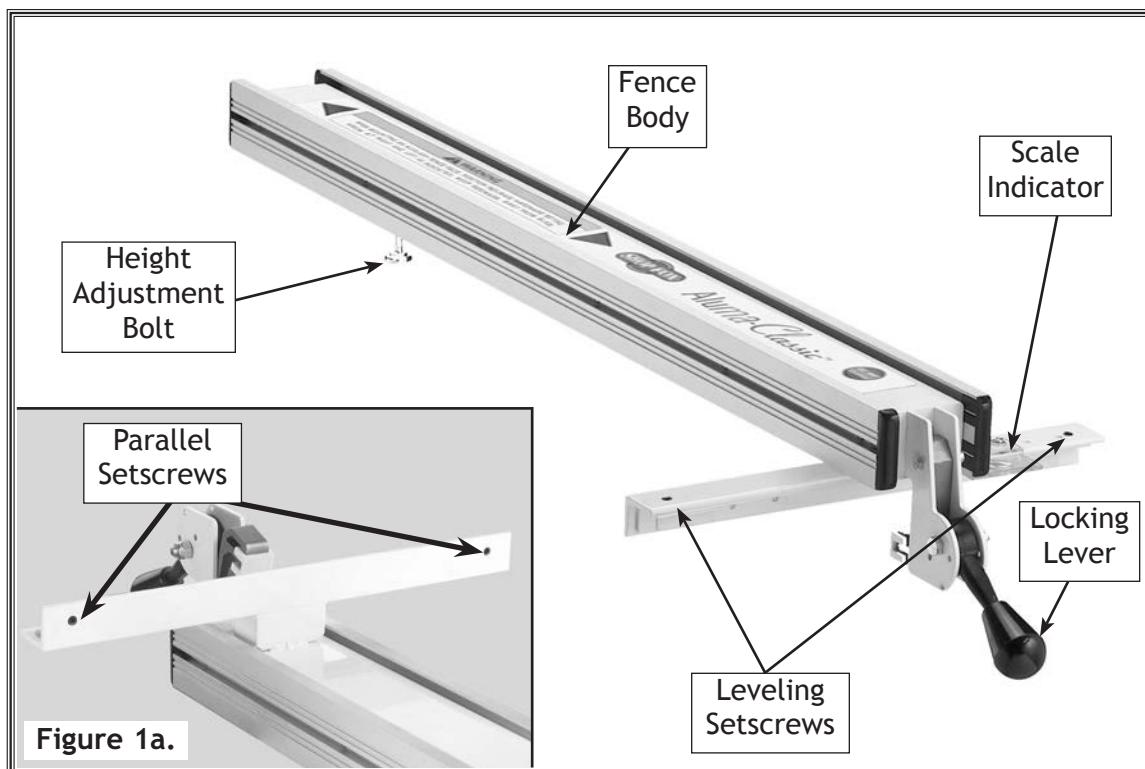

Figure 1. Fence features.

## Unpacking

The **SHOP FOX®** W1716/W1720 has been carefully packaged for safe transporting. If you notice the fence has been damaged, please contact Woodstock International Service and Support at 1-360-734-3482 or send e-mail to: [tech-support@shopfox.biz](mailto:tech-support@shopfox.biz)

## Fence Controls

Take the time to familiarize yourself with the features of your new **SHOP FOX®** Model W1716/W1720 Aluma-Classic™ Fence. They will be frequently mentioned throughout the instructions in this manual. **Figure 1** points out the key features and their locations.

# ASSEMBLY

## Inventory

The following is a description of the main components shipped with the **SHOP FOX®** Model W1716/W1720 Aluma-Classic™ Fence. You should lay the components out to easily identify them.

If any parts are missing, find the part number in the back of this manual and contact Woodstock International, Inc. at 360-734-3482 or at: [tech-support@shopfox.biz](mailto:tech-support@shopfox.biz)

### Model W1716:

- Aluma-Classic™ Fence 1
- Fence Handle Knob 1
- Fence Scale Assembly 1
- 48" Front Rail 1
- 57" Front Rail Bracket 1
- 57" Rear Rail 1
- 30" Scale 1
- W1716 Hardware Bag 1

### Model W1720:

- Aluma-Classic™ Fence 1
- 79" Front Fence Rails 1
- 79" Rear Fence Rails 1
- Rail End Caps 4
- Phillips Head Tap Screw #8 x 3/8" 4
- Legs 2
- Feet 2
- 50" Scale 1
- W1720 Hardware Bag 1

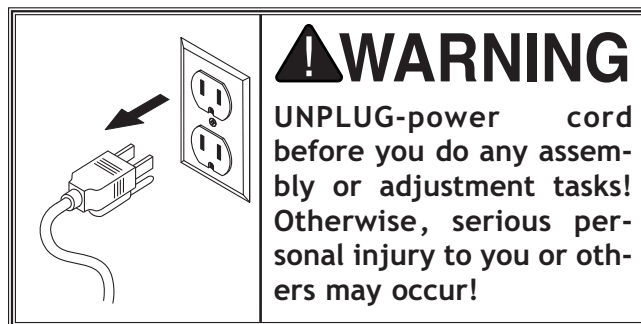
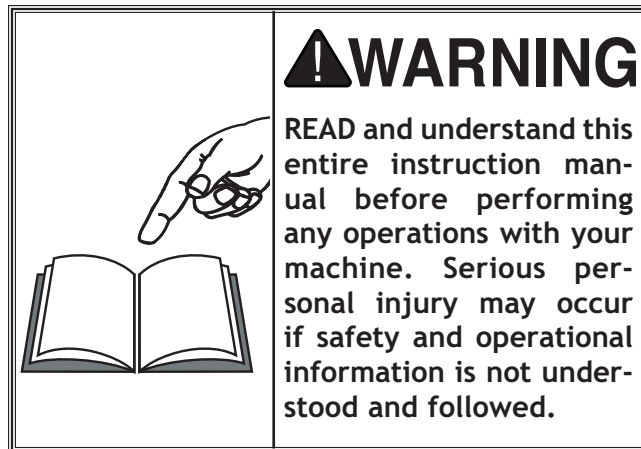

# W1716 Installation

The **SHOP FOX®** W1716 Aluma-Classic™ Fence comes in a box with its own hardware bag.

W1716 Hardware Bag Contents:	Qty
• Cap Screws $\frac{5}{16}$ "-18 x 1"	4
• Flat Washers $\frac{5}{16}$ "	8
• Flat Washers $\frac{1}{4}$ "	6
• Lock Washers $\frac{1}{4}$ "	6
• Hex Nuts $\frac{5}{16}$ "-18	8
• Hex Bolts $\frac{1}{4}$ "-20 x $\frac{3}{4}$ "	6
• Flat Head Screws $\frac{5}{16}$ "-18 x 1"	4
• Hex Key 6mm	1
• Hex Key 4mm	1

To install the fence rail to the table saw, do these steps:

1. Install the rear rail bracket (long angle iron) to the back side of the table (**Figure 2**), with the four  $\frac{5}{16}$ " cap screws. The holes in the extension wings are not threaded and require  $\frac{5}{16}$ " nuts and washers to secure them.
2. Install the front fence rail bracket.
  - If your table saw has cast iron extension tables, install the front rail bracket to the main table with two  $\frac{5}{16}$ "-18 x 1" flat head screws, washers and hex nuts, as shown in **Figure 3**.
  - If your table saw has sheet metal extension tables, install the front bracket to the main table with two  $\frac{5}{16}$ "-18 x 1" flat head screws, washers and hex nuts. Also, secure the front rail bracket to each extension table (**Figure 3**) with a  $\frac{5}{16}$ "-18 x 1" flat head screw, washer and hex nut.

If the extension tables do not have mounting holes, or if the holes in the front fence rail bracket and extension tables do not align, drill  $\frac{5}{16}$ " holes into the extension tables.

3. Align the front rail (rectangular tubing) threaded holes over the front rail bracket holes and secure it in place with the provided six  $\frac{1}{4}$ "-20 x  $\frac{3}{4}$ " hex bolts, flat washers, and lock washers (see **Figure 4**).



**Figure 2.** Rear fence rail bracket.

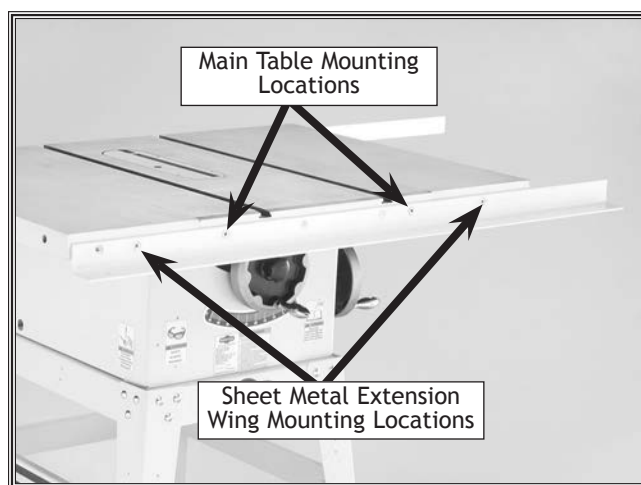

**Figure 3.** Front fence rail bracket.



**Figure 4.** Installing fence tubing.

To install the rip fence to the table saw, do these steps:

1. Thread the handle knob onto the fence locking handle.
2. Make sure the handle is in the unlocked "UP" position before placing the fence on the rails.
3. Check to see that the fence clears the table surface throughout its range of travel, and increase or decrease the height between the fence and table by adjusting the bolt shown in **Figure 5**.
4. Install the clear scale indicator to the right of the fence with the #10-24 x  $\frac{3}{8}$ " Phillips head screws and #10 washers (**Figure 6**).



**Figure 5.** Adjustment bolt.

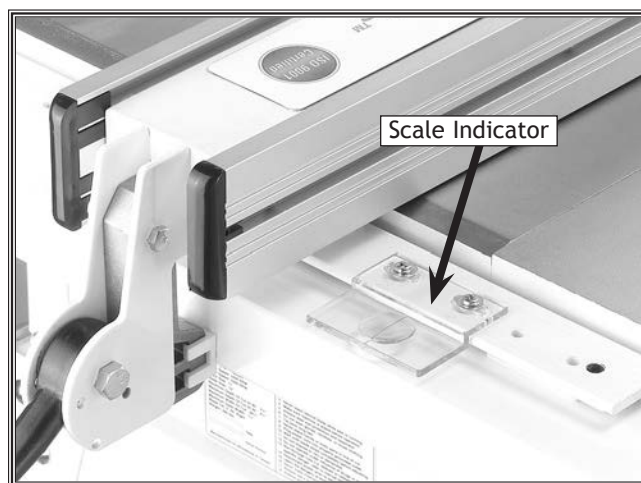

**Figure 6.** Scale indicator.

## W1720 Installation

The **SHOP FOX®** W1720 Aluma-Classic™ Fence with 79" rails mounts to most table saws.

**Figure 7** shows the inventory for the W1720 (Fence not shown).

W1720 Hardware Bag Contents:	Qty
• Flat Washer $\frac{1}{4}$ "	8
• T-Bolt M6-1 x 30	8
• Hex Nut M6-1	8
• Flat Washer $\frac{5}{16}$ "	10
• T-Bolt $\frac{5}{16}$ "-18 x $\frac{3}{4}$ "	10
• Hex Nut $\frac{5}{16}$ "-18	10

To install the W1720 fence rails to the table saw, do these steps:

1. Remove the fence, the standard rails, and the blade guard that came with the table saw, if they are installed.
2. In the front and back edge of the table, insert eight M6-1.0 x 30 T-bolts (four on each side) through the larger threaded holes, and install the flat washers and nuts on each bolt. See **Figure 8**.



**Figure 7.** Extension rail inventory.



3. Insert two  $\frac{5}{16}$ "-18 x  $\frac{3}{4}$ " T-bolts in the right table wing, and two into the edge of the left table wing, and install the flat washers and nuts on each bolt. See **Figure 8**.
4. Tighten all nuts until there is a gap of approximately  $\frac{3}{16}$ " to  $\frac{1}{4}$ " between the T-bolt and the table and wing edges.
5. Slide the extension rail over the T-bolts as shown in **Figure 1** until the rail is flush with the end edge of the left table wing.
6. Tighten all hex nuts.
7. On each leg flange fasten two  $\frac{5}{16}$ "-18 x  $\frac{3}{4}$ " T-bolts, flat washers, and the nuts; then slide the legs onto the rails as shown in **Figure 9**.
8. Tighten the hex nuts to secure the legs to the rails, and secure the rail end caps with the Phillips head screws.
9. Insert two  $\frac{5}{16}$ "-18 x  $\frac{3}{4}$ " T-bolts into the start switch mounting slot (see **Figure 8**), and position the start switch mounting bracket to the underside of the rail, and secure it with the washers and nuts.
10. Install fence, and adjust rails to fine-tune the mounting alignment of the rails and legs.

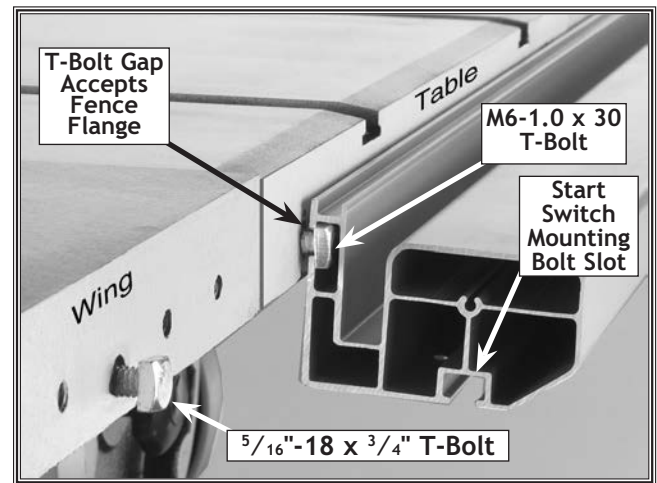

**Figure 8.** Front rail being slid onto T-bolts.

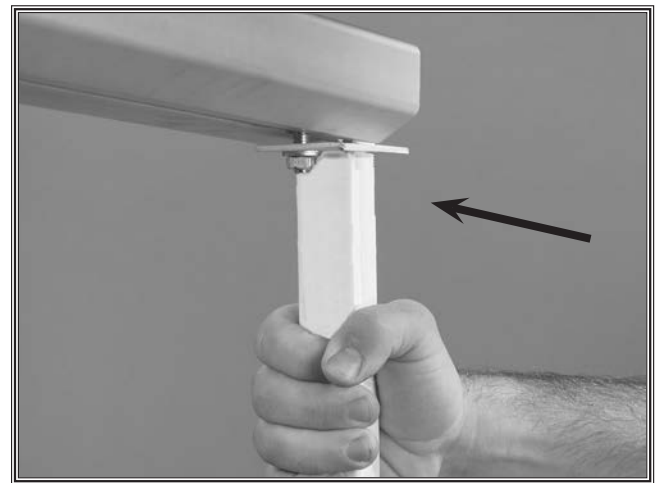

**Figure 9.** Sliding rail leg into table.

# Installing Metal Extension Wings

The **SHOP FOX**® Model W1722 Heavy-Duty Metal Extension Wings (**Figure 10**) can be installed on the Model W1720 79" rails.

W1722 Hardware Bag Contents:	Qty
• Flat Washer $\frac{5}{16}$ "	12
• T-Bolt $\frac{5}{16}$ " -18 x 1"	12
• Hex Nut $\frac{5}{16}$ "-18	12

To install the W1722 extension wings, do these steps:

1. Loosely install the T-bolts, washers and hex nuts into the short sides of the extension wings.
2. Insert the T-bolt heads into the rail T-slots as shown in **Figure 11**.
3. Slide the tables into place as shown in **Figure 12**. Note—*The tables slide into place easily if you lift up while you slide them into place.*
4. Place a straightedge across the top of the wings, and tighten the nuts behind the edge of the extension wings to secure the wings in place.

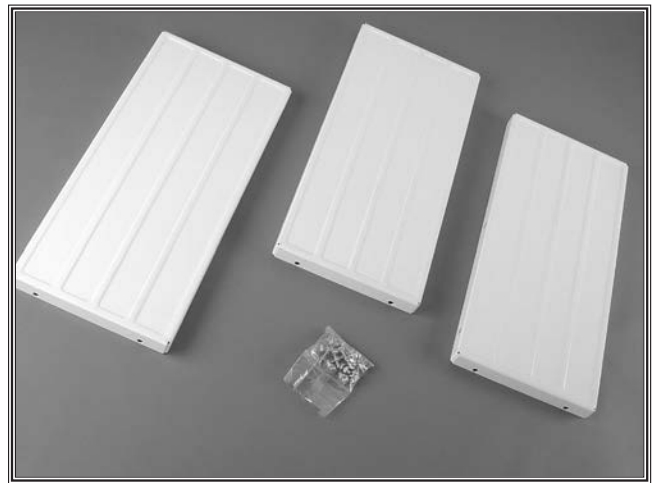

**Figure 10.** Extension wing box inventory.



**Figure 11.** T-bolt and rail T-slot.

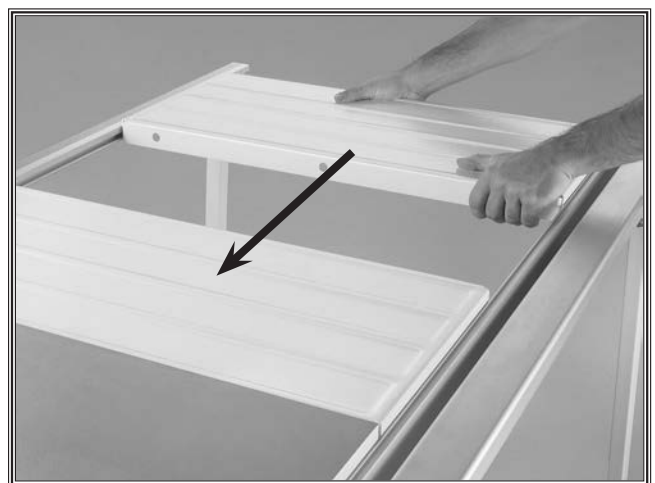

**Figure 12.** Sliding in the wings.

# ADJUSTMENTS

The SHOP FOX® W1716/W1720 Aluma-Classic™ Fence requires little adjustment since most of the features are built in at the factory. The primary adjustment is to position the fence so it is parallel to the saw blade.

## Fence Parallelism

If your table saw has been properly adjusted, the saw blade should be parallel to the miter slot. Refer to your table saw manual for the proper procedure to check and adjust the saw blade to the miter slot correctly.

To adjust the SHOP FOX® Aluma-Classic™ Fence parallel with the miter slot, do these steps:

1. **UNPLUG THE TABLE SAW!**
2. Align the edge of the fence with the edge of the miter slot.
3. Lock the fence and check the alignment between the left edge and the miter slot.
4. Adjust the setscrews shown in **Figure 13** to adjust the angle of the fence. Note— *The left setscrew will move the fence left and the right setscrew will move the fence right.*
5. Adjust the fence until the back end falls  $\frac{1}{64}$ " away from the miter slot so the work-piece clears the opposite end of the saw blade without binding. This is called "lead" (pronounced *lead*).

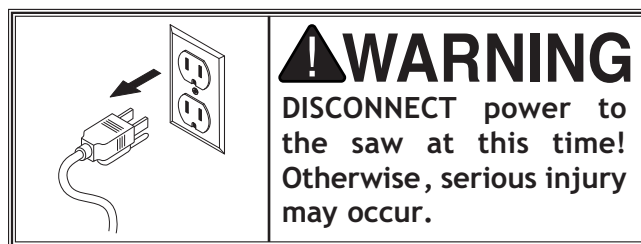

**Figure 13.** Fence adjustment setscrews.

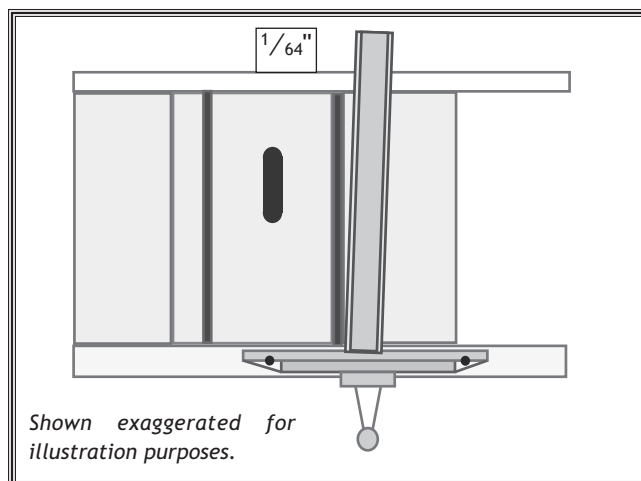

**Figure 14.** Lead adjustment.

## ! WARNING

**KICK-BACK! DO NOT** cut on the left side of the blade if the fence lead is adjusted for cutting on the right side of the blade. Re-adjust the lead when changing the side of the blade you are cutting on.

# Scale Installation & Adjustment

The self-adhesive scale provides fast and accurate fence positioning. It is best to install the scale after all other adjustments in this section have been made. **Figure 15** shows the scale properly installed on the front rail.

To install the scale indicator, do these steps:

1. **UNPLUG THE TABLE SAW!**
2. Raise the blade to its maximum height.
3. Position the fence against the right side of the blade.
4. Carefully place the scale along the front rail about  $\frac{1}{2}$ " away from the edge and underneath the scale indicator. Note—*Do not stretch the tape! This will cause inaccurate cuts.*
5. Position the "0" mark on the scale under the cursor hairline and secure the scale to the rail.
6. Adjust the cursor left or right so the hairline is directly over the "0" mark on the scale.
7. Make a test cut then measure the thickness of your test board.
8. Fine tune the hairline indicator to correspond with the actual test board thickness. This method accounts for any vibration or wobble that may be present in the spinning blade.



**Figure 15.** Scale installed on front rail.

# W1716 SHOP FOX® Aluma-Classic™ Fence

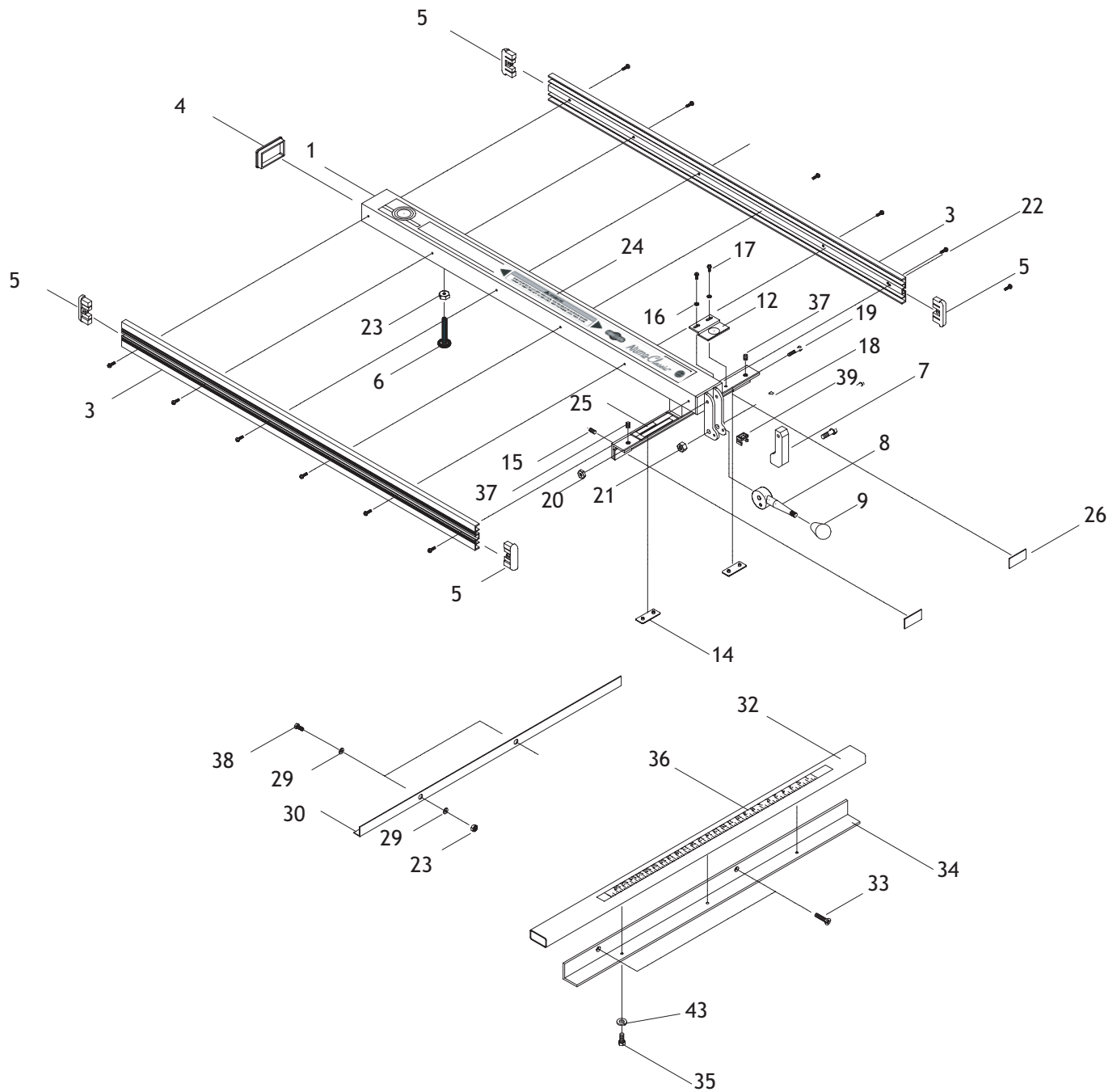

## W1716 SHOP FOX® Aluma-Classic™ Fence

REF	PART #	DESCRIPTION
1	X1716001	FENCE BODY ASSEMBLY
3	X1716003	FENCE SIDEBOARD
4	X1716004	FENCE PLUG
5	X1716005	FENCE SIDEBOARD CAP
6	X1716006	ADJUSTMENT BOLT $\frac{5}{16}$ "-18
7	X1716007	CLAMP
8	X1716008	HANDLE
9	X1716009	FEMALE KNOB
12	X1716012	CLEAR INDICATOR
14	X1716014	SLIDER 19 X 50 X 2T
15	X1716015	SETSCREW $\frac{5}{16}$ "-18 X $\frac{1}{4}$ "
16	X1716016	FLAT WASHER #10
17	X1716017	PHLP HD SCR 10-24 X $\frac{3}{8}$ "
18	X1716018	HEX BOLT $\frac{3}{8}$ "-16 X $1\frac{3}{4}$ "
19	X1716019	HEX BOLT $\frac{1}{4}$ "-20 X $1\frac{3}{4}$ "
20	X1716020	LOCK NUT $\frac{1}{4}$ "-20
21	X1716021	LOCK NUT $\frac{3}{8}$ "-16
22	X1716022	PHLP HD SCR 8-32 X $\frac{3}{8}$ "
23	X1716023	HEX NUT $\frac{5}{16}$ "-18
24	X1716024	ALUMA-CLASSIC™ LABEL
25	X1716025	WARNING LABEL (SHORT)
26	X1716026	SLIDER 19 X 50 X 1.2T
29	X1716029	FLAT WASHER $\frac{5}{16}$ "
30	X1716030	REAR RAIL
32	X1716032	FRONT RAIL
33	X1716033	FLAT HD SCR $\frac{5}{16}$ "-18 X 1
34	X1716033	FRONT RAIL BRACKET
35	X1716035	HEX BOLT $\frac{1}{4}$ "-20 X $\frac{3}{4}$ "
36	X1716036	SCALE 30"
37	X1716037	SETSCREW $\frac{5}{16}$ "-18 X $\frac{1}{4}$ "
38	X1716038	CAP SCREW $\frac{5}{16}$ "-18 X 1
39	X1716039	CLAMP PLUG
43	X1716043	LOCK WASHER $\frac{1}{4}$ "

# W1720 SHOP FOX® Aluma-Classic™ Fence

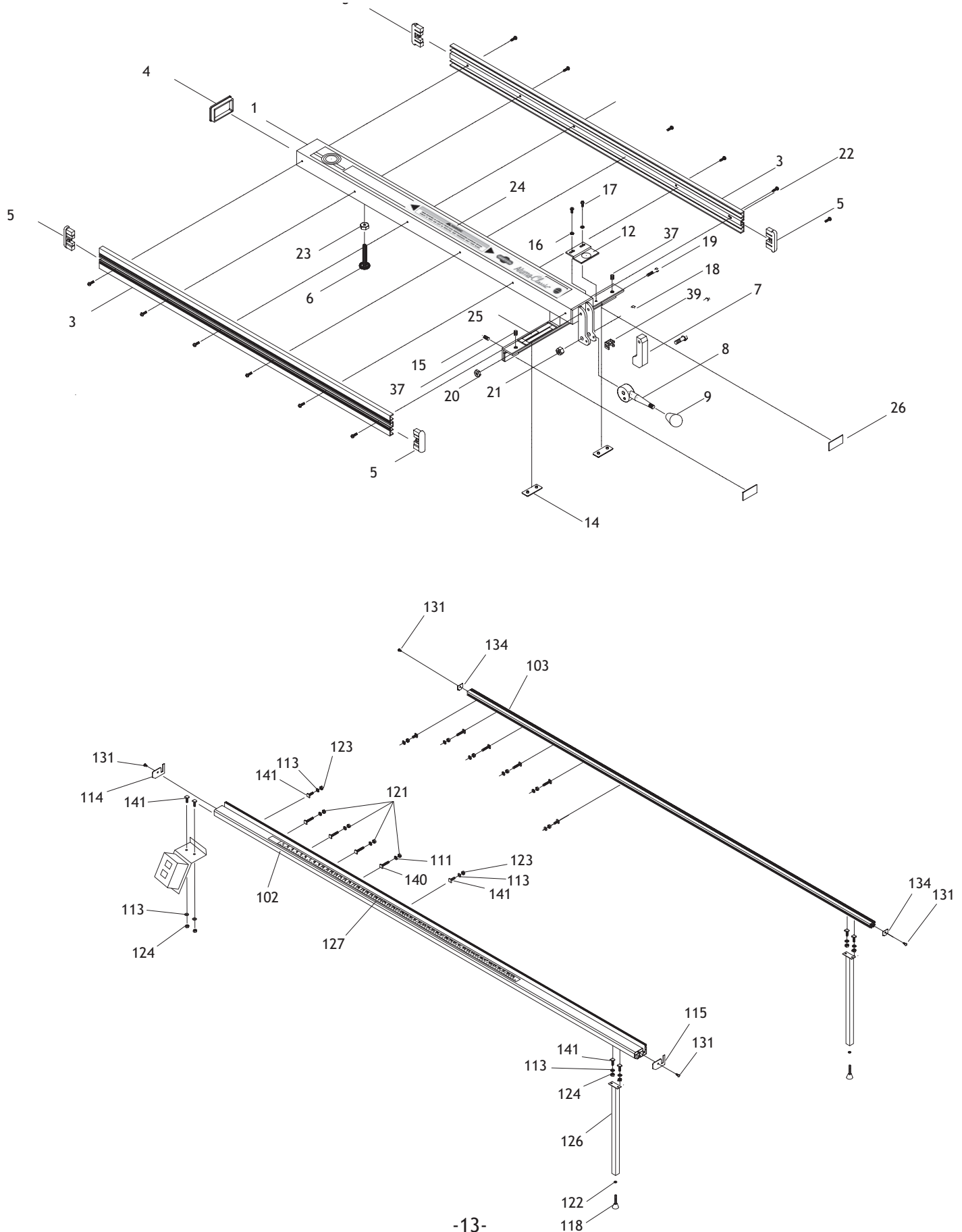

## W1720 SHOP FOX® Aluma-Classic™ Fence

REF	PART #	DESCRIPTION
1	X1720001	FENCE BODY ASSEMBLY
3	X1720003	FENCE SIDEBOARD
4	X1720004	FENCE PLUG
5	X1720005	FENCE SIDEBOARD CAP
6	X1720006	ADJUSTMENT BOLT $\frac{5}{16}$ "-18
7	X1720007	CLAMP
8	X1720008	HANDLE
9	X1720009	FEMALE KNOB
12	X1720012	CLEAR INDICATOR
14	X1720014	SLIDER 19 X 50 X 2T
15	X1720015	SETSCREW $\frac{5}{16}$ "-18 X $\frac{1}{4}$ "
16	X1720016	FLAT WASHER #10
17	X1720017	PHLP HD SCR 10-24 X $\frac{3}{8}$ "
18	X1720018	HEX BOLT $\frac{3}{8}$ "-16 X $1\frac{3}{4}$ "
19	X1720019	HEX BOLT $\frac{1}{4}$ "-20 X $1\frac{3}{4}$ "
20	X1720020	LOCK NUT $\frac{1}{4}$ "-20
21	X1720021	LOCK NUT $\frac{3}{8}$ "-16
22	X1720022	PHLP HD SCR 8-32 X $\frac{3}{8}$ "
24	X1720024	ALUMA-CLASSIC™ LABEL
25	X1720025	WARNING LABEL (SHORT)

REF	PART #	DESCRIPTION
26	X1720026	SLIDER 19 X 50 X 1.2T
37	X1720037	SETSCREW $\frac{5}{16}$ "-18 X $\frac{1}{4}$ "
39	X1720039	CLAMP PLUG
102	X1720102	ALUMINUM FRONT RAIL
103	X1720102	ALUMINUM REAR RAIL
111	X1720111	FLAT WASHER 6MM
113	X1720113	FLAT WASHER $\frac{5}{16}$ "
114	X1720114	FRONT RAIL CAP (L)
115	X1720115	FRONT RAIL CAP (R)
118	X1720118	RUBBER FOOT BOLT
121	X1720121	HEX NUT M6-1
122	X1720122	HEX NUT $\frac{3}{8}$ "-16
123	X1720123	HEX NUT $\frac{5}{16}$ "-18
124	X1720124	HEX NUT $\frac{5}{16}$ "-18
126	X1720126	LEG (LONG)
127	X1720127	LENGTH SCALE 50"
131	X1720131	SELF TAP SCREW #8 X $\frac{3}{8}$ "
134	X1720134	REAR RAIL CAP
140	X1720140	SQUARE BOLT M6-1 X 30
141	X1720141	SQUARE BOLT $\frac{5}{16}$ "-18 X $\frac{3}{4}$ "



# Warranty Registration

Name \_\_\_\_\_  
Street \_\_\_\_\_  
City \_\_\_\_\_ State \_\_\_\_\_ Zip \_\_\_\_\_  
Phone # \_\_\_\_\_ Email \_\_\_\_\_ Invoice # \_\_\_\_\_  
Model # \_\_\_\_\_ Serial # \_\_\_\_\_ Dealer Name \_\_\_\_\_ Purchase Date \_\_\_\_\_

*The following information is given on a voluntary basis. It will be used for marketing purposes to help us develop better products and services. Of course, all information is strictly confidential.*

1. How did you learn about us?  
☐ Advertisement      ☐ Friend      ☐ Local Store  
☐ Mail Order Catalog      ☐ Website      ☐ Other:
2. How long have you been a woodworker/metalworker?  
☐ 0-2 Years      ☐ 2-8 Years      ☐ 8-20 Years      ☐ 20+ Years
3. How many of your machines or tools are Shop Fox?  
☐ 0-2      ☐ 3-5      ☐ 6-9      ☐ 10+
4. Do you think your machine represents a good value?      ☐ Yes      ☐ No
5. Would you recommend Shop Fox products to a friend?      ☐ Yes      ☐ No
6. What is your age group?  
☐ 20-29      ☐ 30-39      ☐ 40-49  
☐ 50-59      ☐ 60-69      ☐ 70+
7. What is your annual household income?  
☐ \$20,000-\$29,000      ☐ \$30,000-\$39,000      ☐ \$40,000-\$49,000  
☐ \$50,000-\$59,000      ☐ \$60,000-\$69,000      ☐ \$70,000+
8. Which of the following magazines do you subscribe to?

<input type="checkbox"/> Cabinet Maker	<input type="checkbox"/> Popular Mechanics	<input type="checkbox"/> Today's Homeowner
<input type="checkbox"/> Family Handyman	<input type="checkbox"/> Popular Science	<input type="checkbox"/> Wood
<input type="checkbox"/> Hand Loader	<input type="checkbox"/> Popular Woodworking	<input type="checkbox"/> Wooden Boat
<input type="checkbox"/> Handy	<input type="checkbox"/> Practical Homeowner	<input type="checkbox"/> Woodshop News
<input type="checkbox"/> Home Shop Machinist	<input type="checkbox"/> Precision Shooter	<input type="checkbox"/> Woodsmith
<input type="checkbox"/> Journal of Light Cont.	<input type="checkbox"/> Projects in Metal	<input type="checkbox"/> Woodwork
<input type="checkbox"/> Live Steam	<input type="checkbox"/> RC Modeler	<input type="checkbox"/> Woodworker West
<input type="checkbox"/> Model Airplane News	<input type="checkbox"/> Rifle	<input type="checkbox"/> Woodworker's Journal
<input type="checkbox"/> Modeltec	<input type="checkbox"/> Shop Notes	<input type="checkbox"/> Other:
<input type="checkbox"/> Old House Journal	<input type="checkbox"/> Shotgun News	

9. Comments: \_\_\_\_\_  
\_\_\_\_\_  
\_\_\_\_\_  
\_\_\_\_\_  
\_\_\_\_\_

FOLD ALONG DOTTED LINE



Place  
Stamp  
Here



WOODSTOCK INTERNATIONAL INC.  
P.O. BOX 2309  
BELLINGHAM, WA 98227-2309



FOLD ALONG DOTTED LINE

TAPE ALONG EDGES--PLEASE DO NOT STAPLE



